

ciąg dalszy na stronie 2

Obr. ewid. Siedlakowice

1

88/21
7Js75
c 0.58

87/20
h 80/70
0.31

88/9
j 80/70
0.58

88/26
k 80/70
0.58

88/12
g 70/70
0.63

88/28
f 70/70
0.37

87/21
i 0.19

91/20

10Js50
a 0.06

2

Obr. ewid. Kryształowice

17/3

353

50/60
h 0.08

50/60
i 0.05

50/60
j 0.32

1

11/1

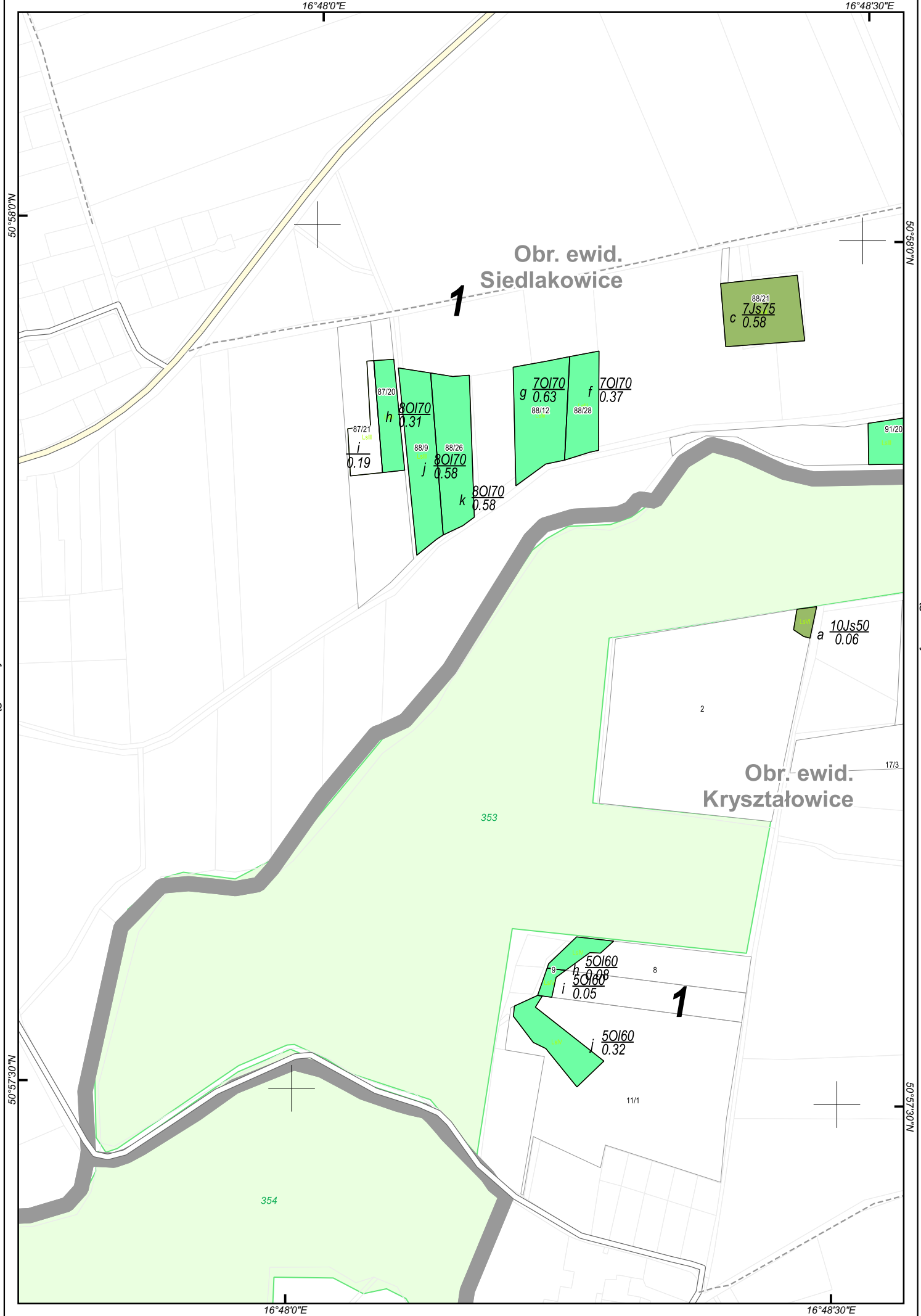

Obr. ewid.
Siedlakowice

1

1



Obr. ewid.
Miroslawice

1

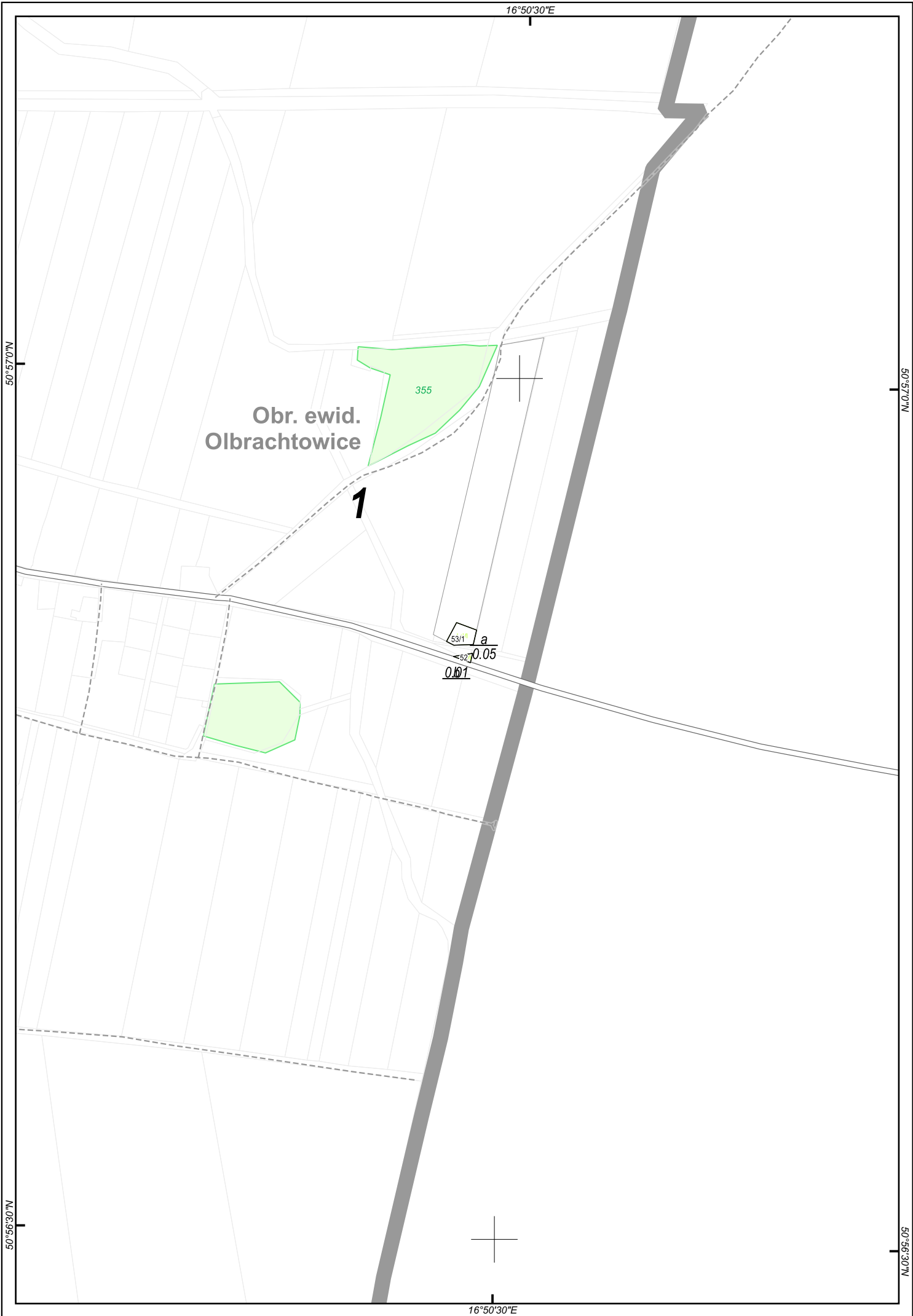

Obr. ewid.
Kryształowice

1

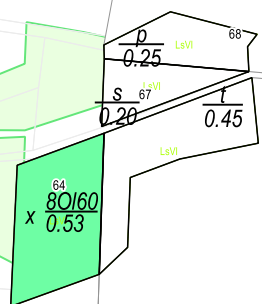

$\frac{70165}{0.06}$

$\frac{70165}{0.14}$

$\frac{70165}{0.50}$

73

Obr. ewid.
Olbrachtowice

1

1

16°48'0"E

16°48'30"E

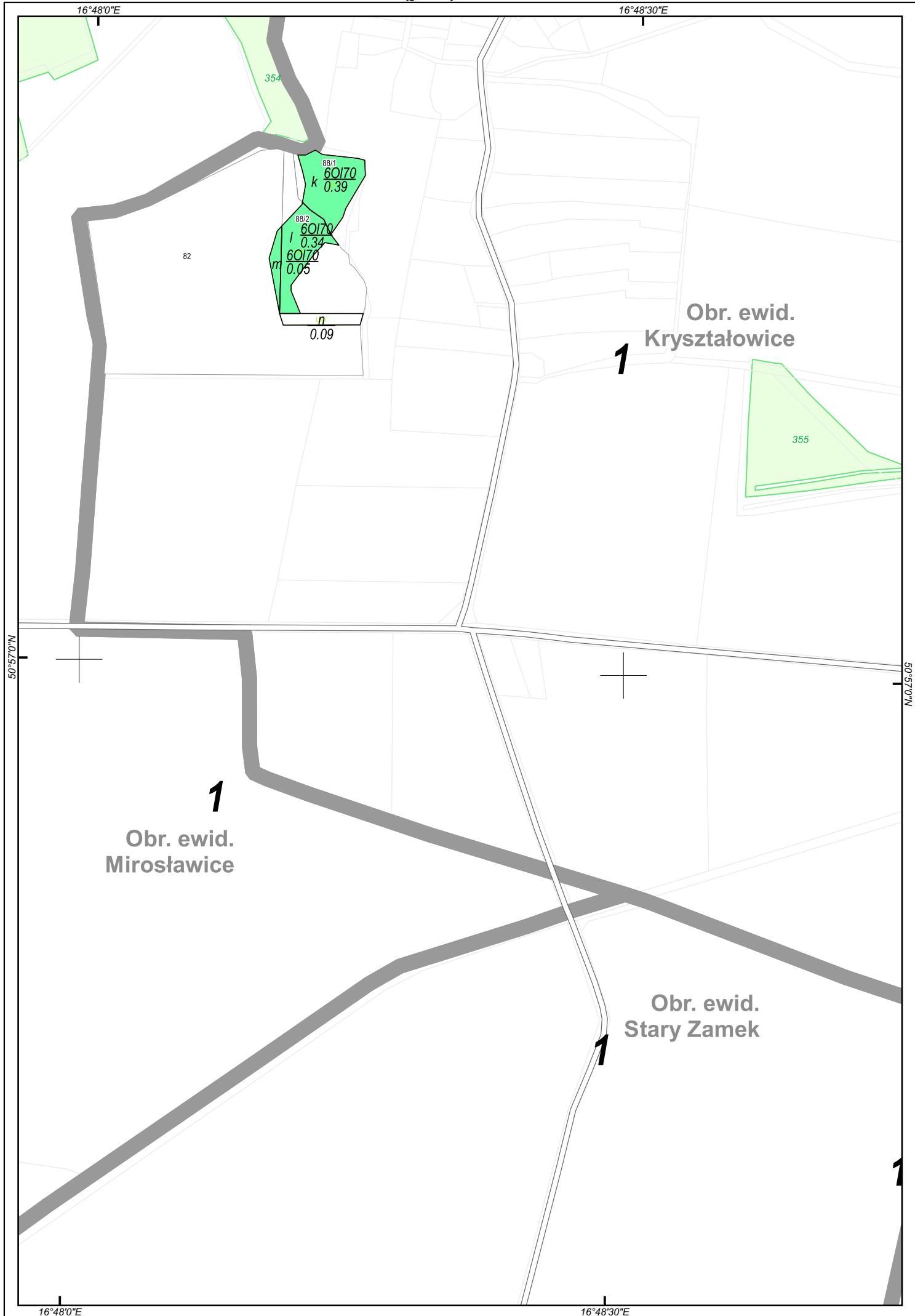

ciąg dalszy na stronie 5

16°48'0"E

16°48'30"E

16°50'30"E

16°51'0"E

50°56'0"N

50°56'0"N

Obr. ewid.
Ręków

1

145
a $\frac{10Js60}{0.41}$

355

b $\frac{L_{124}}{0.12}$

c $\frac{10Tp40}{0.18}$
LsV

50°55'30"N

50°55'30"N

16°50'30"E

16°51'0"E

16°47'30"E

16°48'0"E

355

a
0.09

Obr. ewid.
Stary Zamek

1

50°56'0"N

50°56'0"N

1

Obr. ewid.
Michałowice gm. Sobótka

191 a
0.87

16°47'30"E

16°48'0"E

Obr. ewid. Stary Zamek

1



Obr. ewid. Strachów

Obr. ewid. Kunów

1

12/2 12/1
6Wb50
c 0.13

11/1 10/1
a 0.14

10Db70
d 0.27

21
h LstV
0.19

9Db90
f 0.36

33
6Db80
b 1.75

5/1
plaz
i 0.19

94

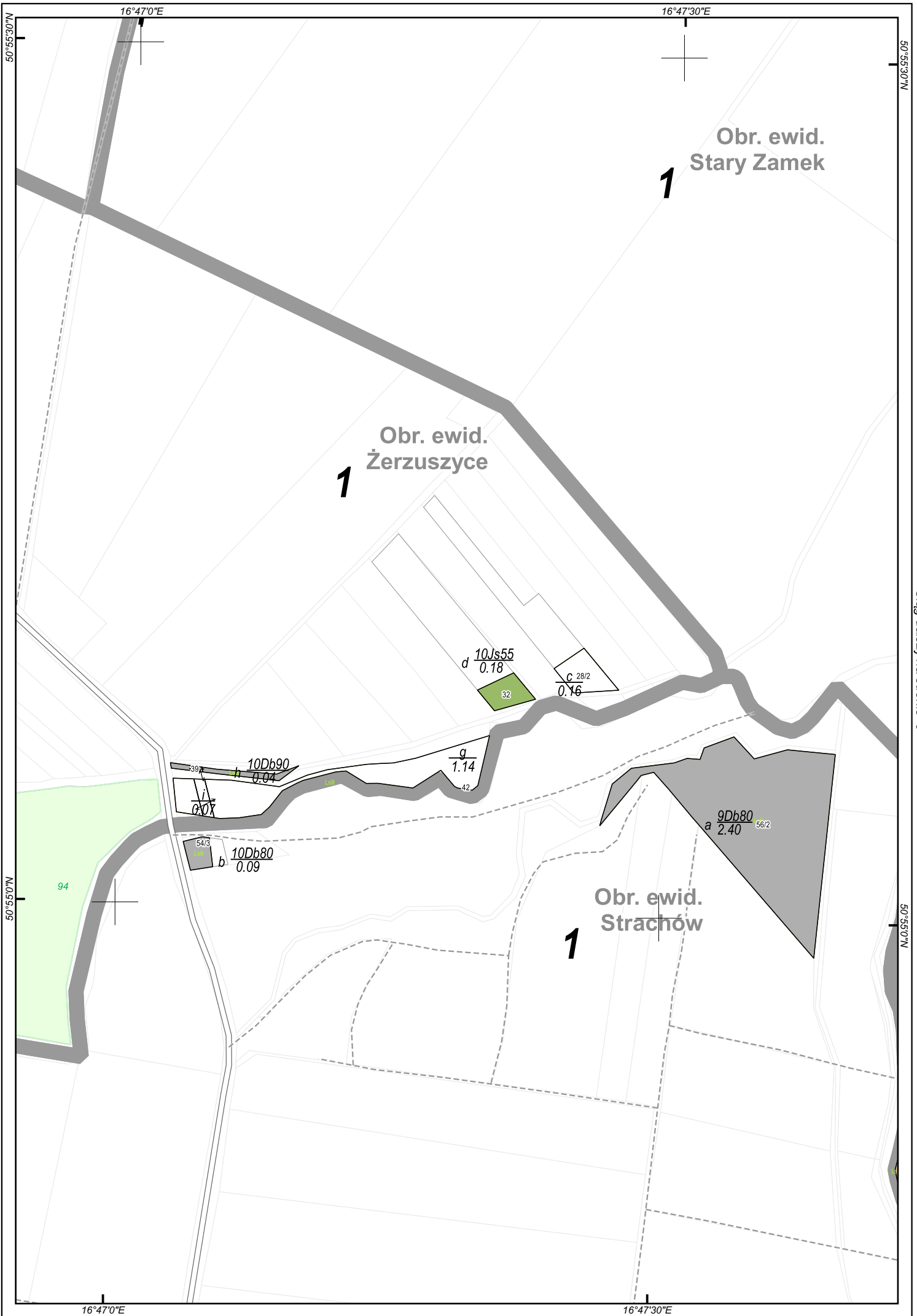

ciąg dalszy na stronie 9

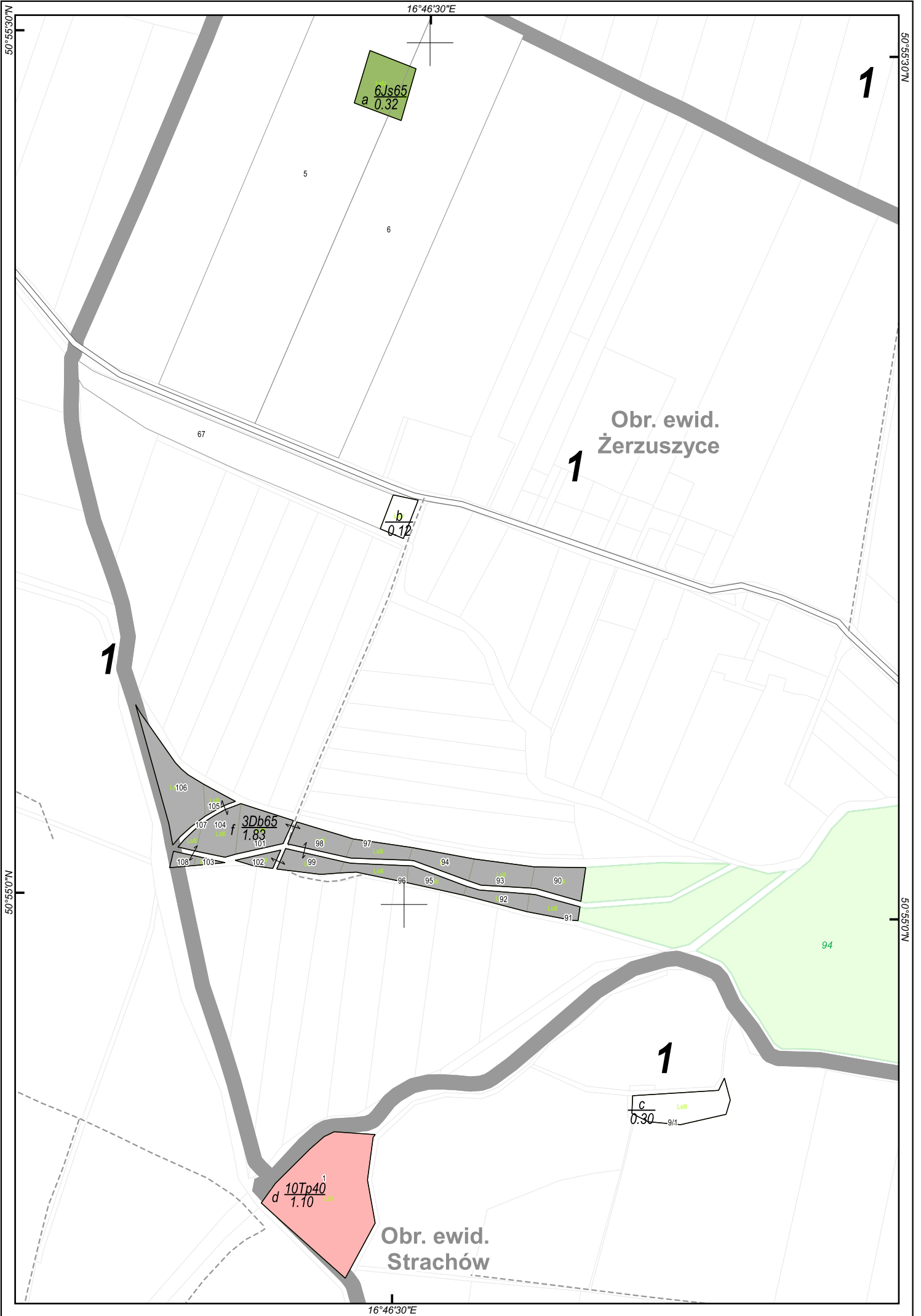

16°43'0"E

16°43'30"E

50°57'0"N

50°57'0"N



Obr. ewid.
Wojnarowice

1

61580
a 0.170
69570
b 0.26

3

50°56'30"N

50°56'30"N



16°43'0"E

16°43'30"E

16°45'0"E

50°55'30"N

50°55'30"N

16°45'0"E



Obr. ewid.
Rogów Sobócki

16°45'30"E

50°54'30"N

50°54'30"N

Obr. ewid.
Rogów Sobócki

1

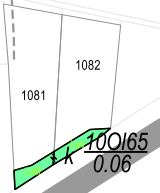
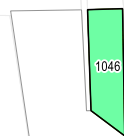
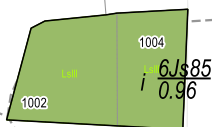

50°54'0"N

50°54'0"N

16°45'30"E

16°46'30"E

16°47'0"E

50°54'30"N

50°54'30"N

16°46'30"E

1

1

Obr. ewid.
Strachów

102

108

101/2

111

$f \frac{8Db80}{0.50}$

110

113

$g \frac{100i40}{0.18}$

114

$j \frac{80i60}{0.60}$

94

Obr. ewid.
Kunów

1

$b \frac{132}{0.04}$

50°54'0"N

16°47'0"E

50°54'0"N

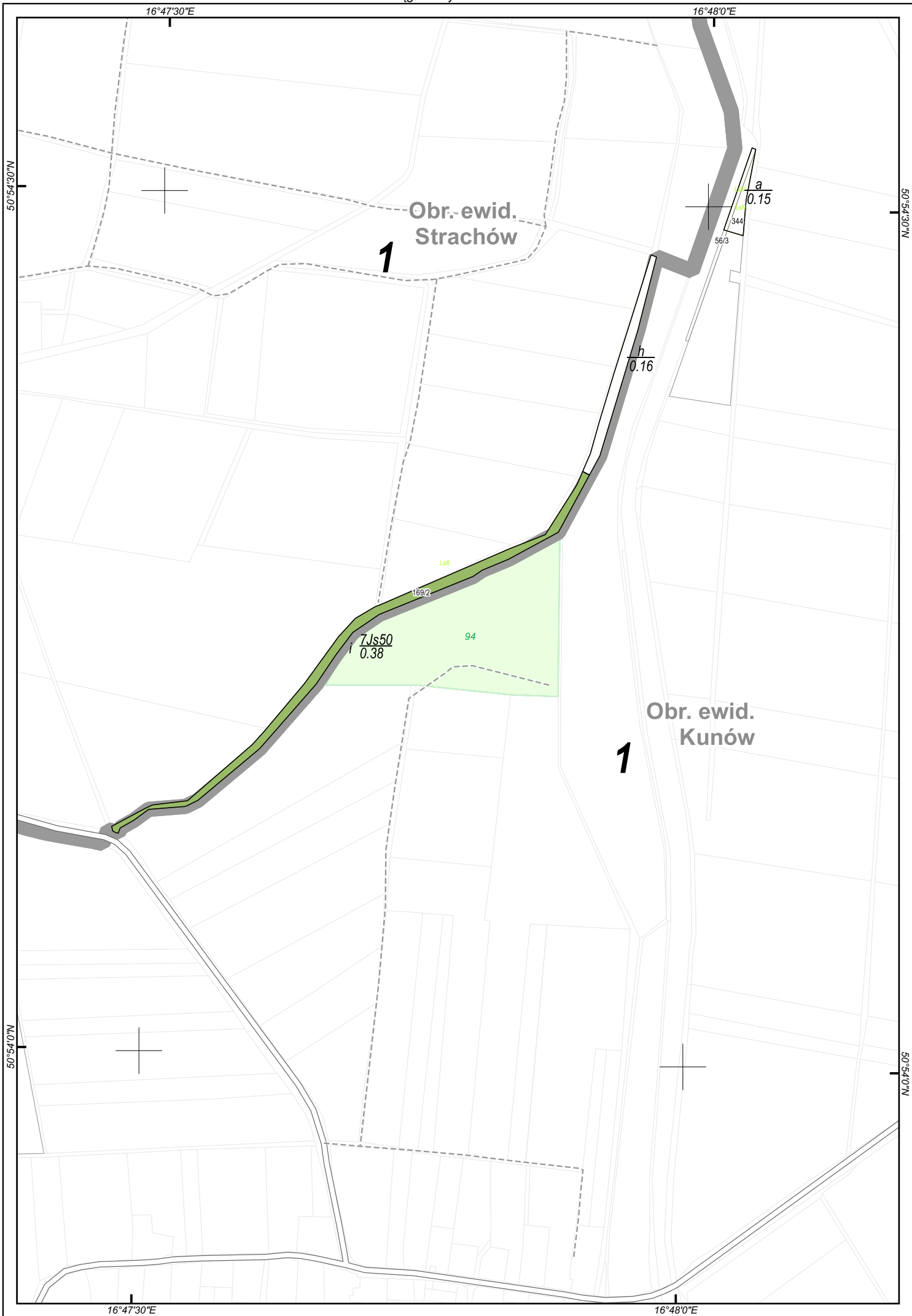

16°49'30"E

16°50'0"E

50°53'0"N

50°53'0"N

Obr. ewid.
Nasławice

1

268/6

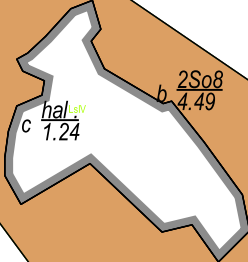

16°49'30"E

50°52'30"N

50°52'30"N

16°50'0"E

16°48'30"E

Obr. ewid.
Kunów

1

Obr. ewid.
Nasławice

1

f $\frac{3Js35}{0.56}$

254/1
303/304

403

50°53'30"N

50°53'30"N

16°48'30"E

ciąg dalszy na stronie 19

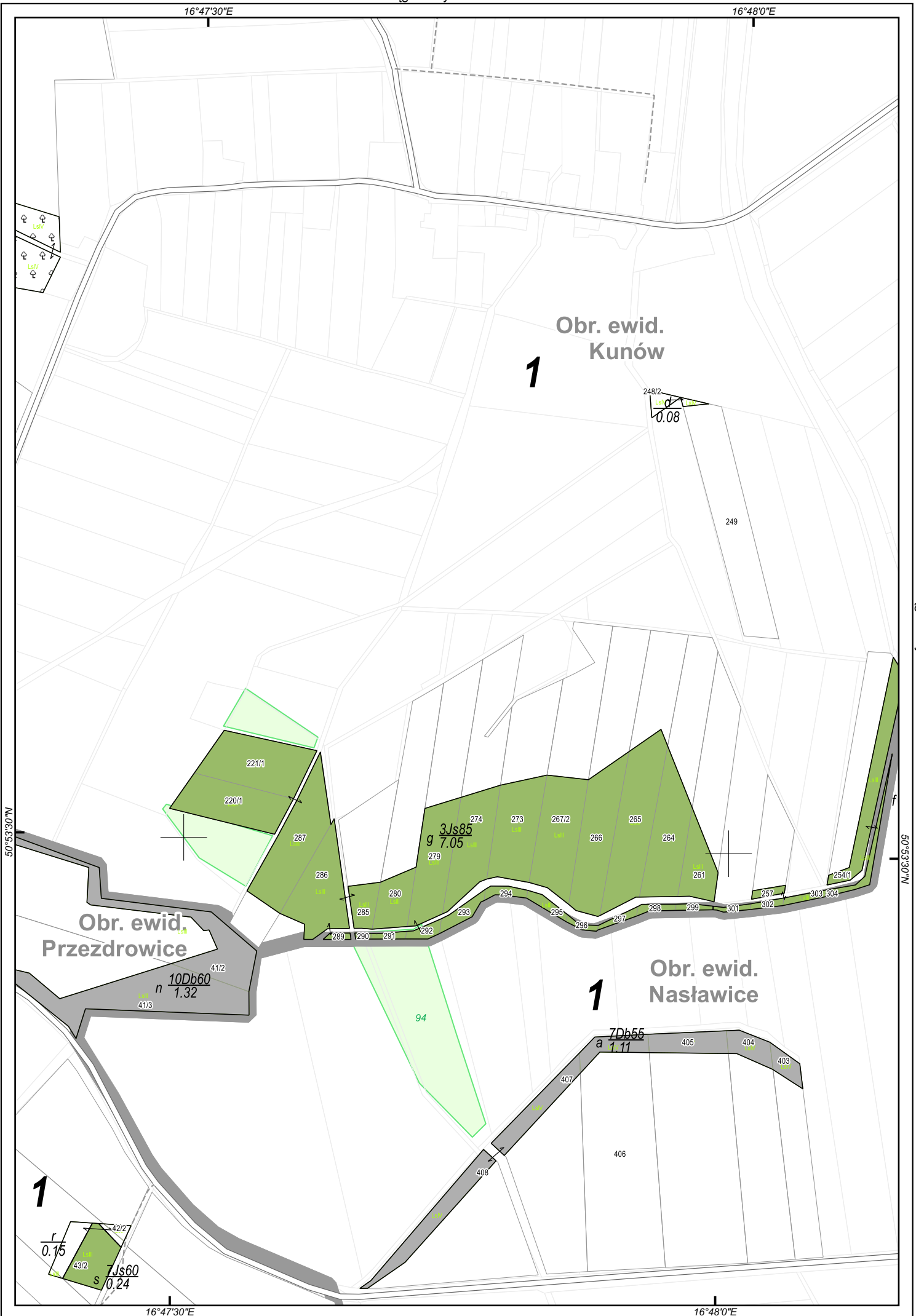

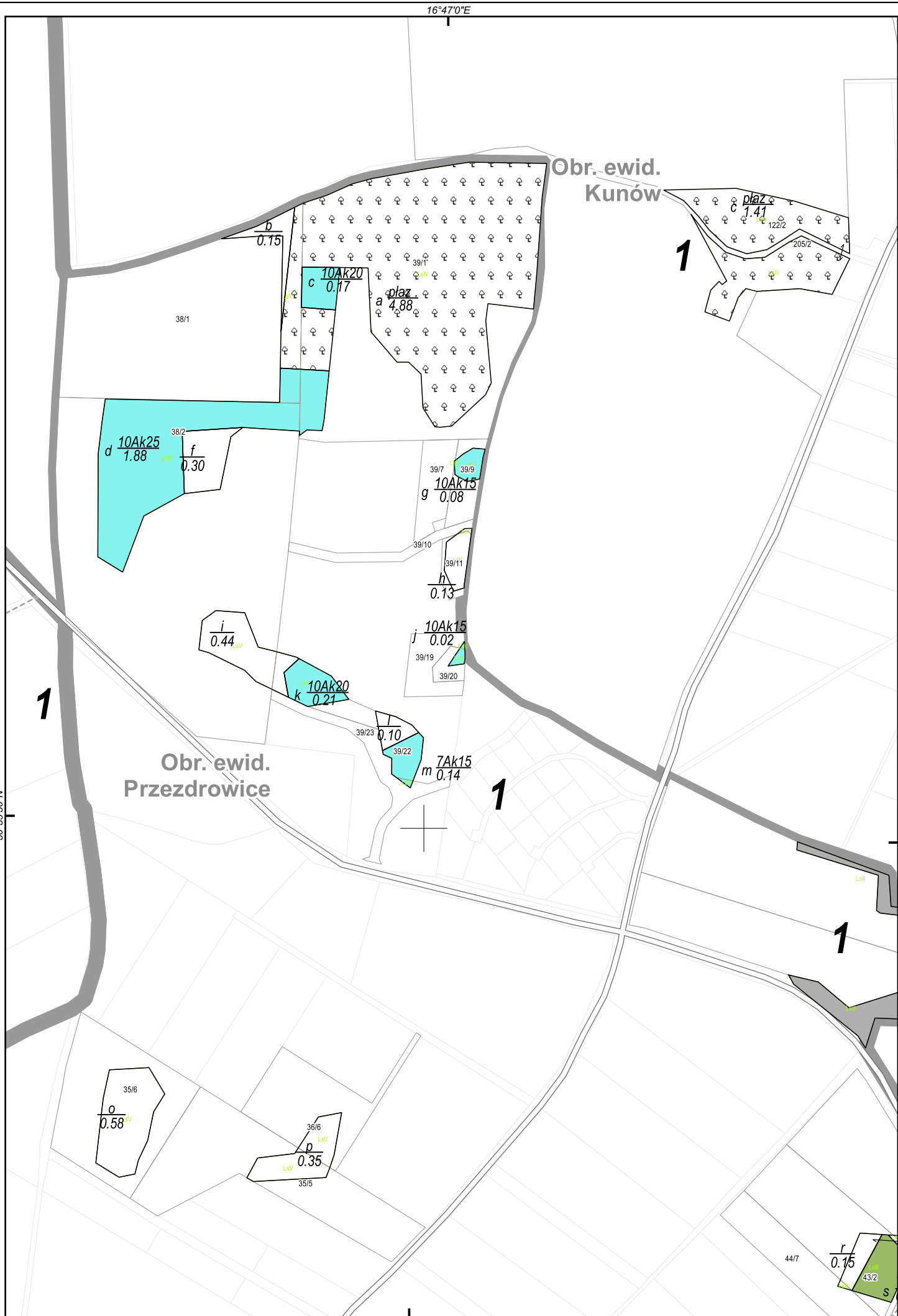

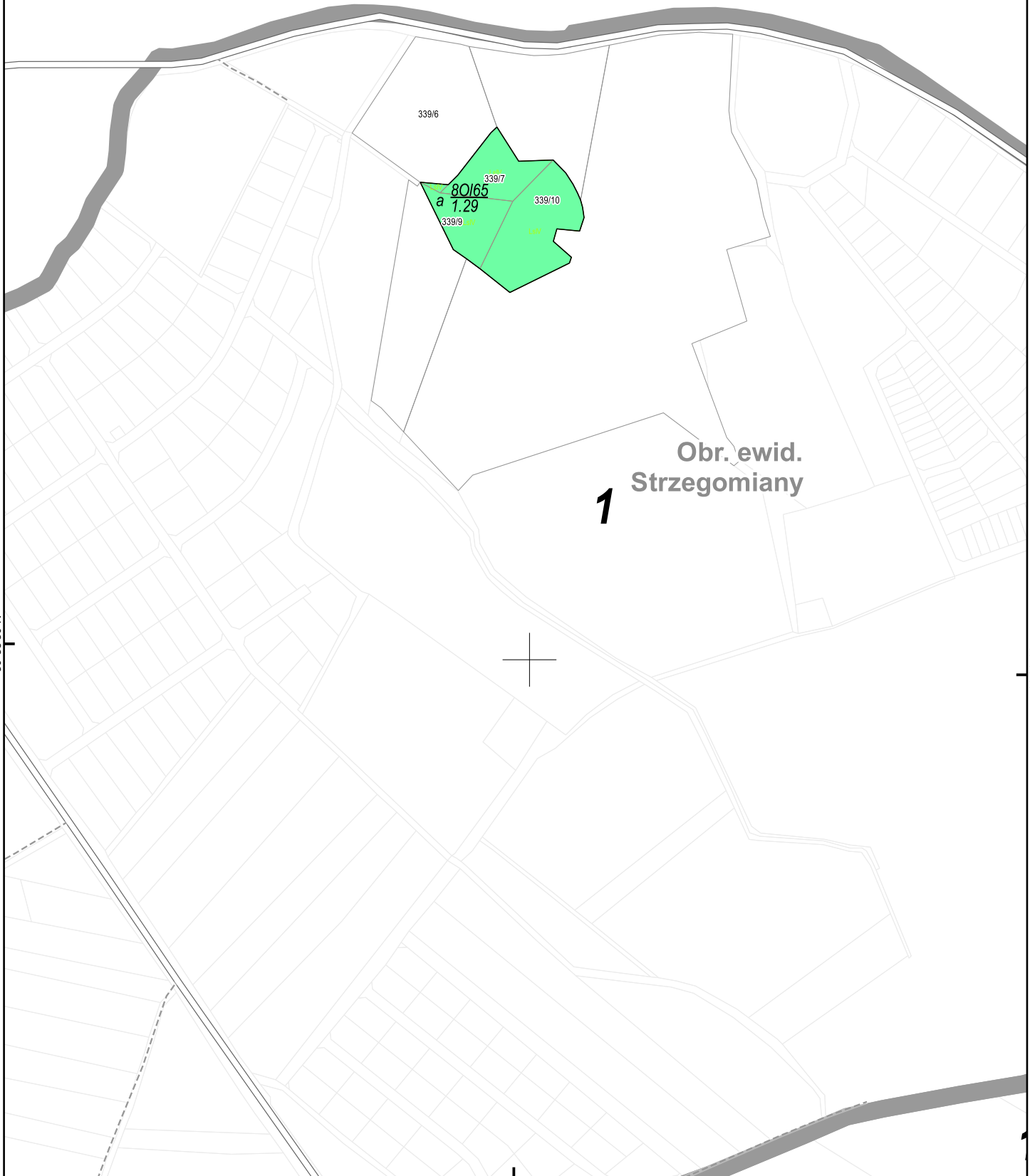

43/2
Js60
s 0,24

Obr. ewid.
Nastawice

1

1

4Js90
ax 3,20

43/3

42/3

44/9

44/8

4Js95
bx 2,30

45/3

Obr. ewid.
Przezdrowice

Obr. ewid.
Świątyniki

1

29/3
30
30/60
a 0,75
b 0,69
94

16°47'0"E

50°35'0"N

50°35'0"N

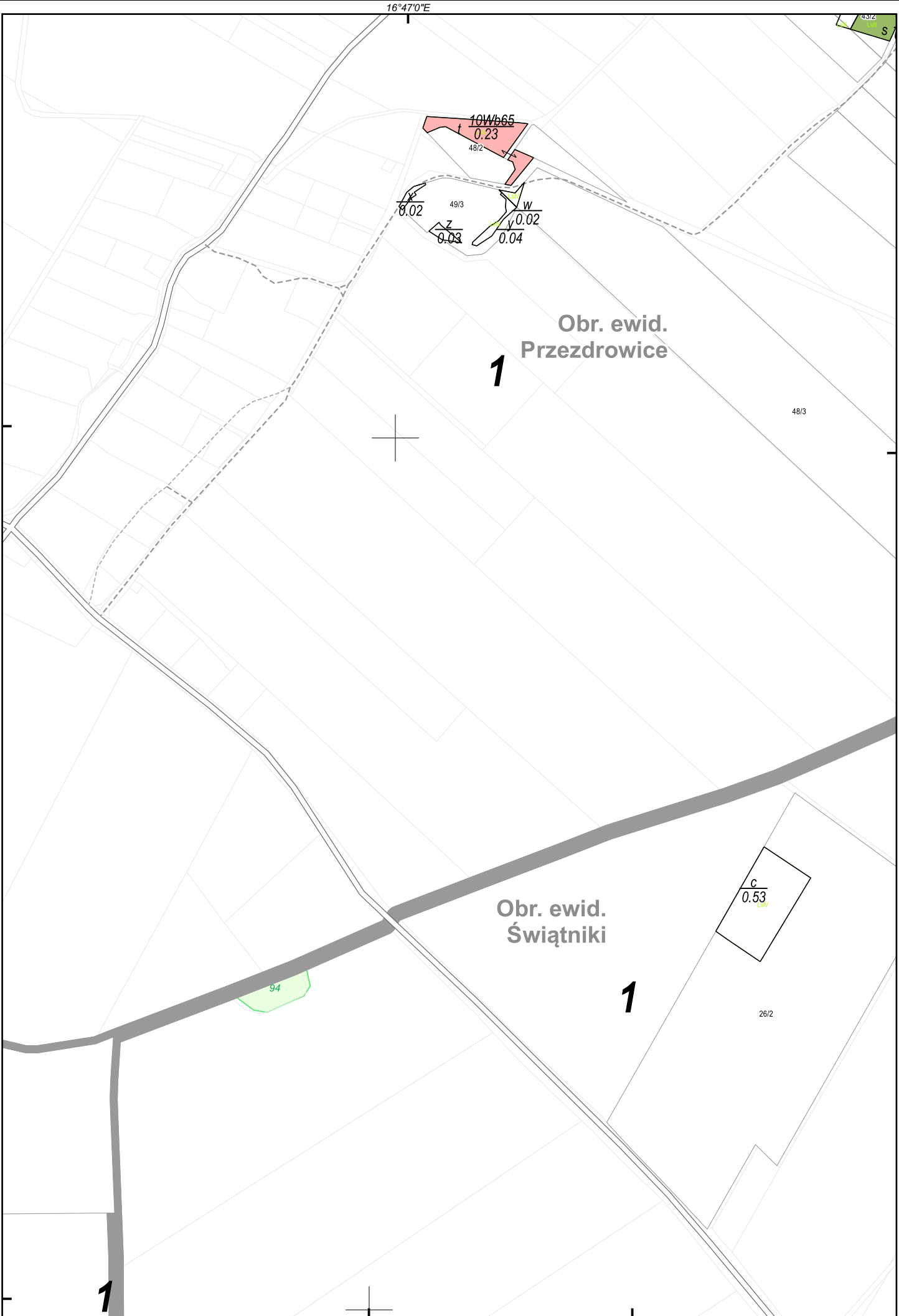

Obr. ewid.
Przewdrowice

1

Obr. ewid.
Świątniki

1

50°35'0"N

16°47'0"E

50°52'30"N

16°46'0"E

16°46'30"E

50°53'0"N

50°53'0"N

Obr. ewid.
Strzegomiany

Obr. ewid.
Przedzrowice

1

1

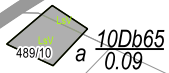
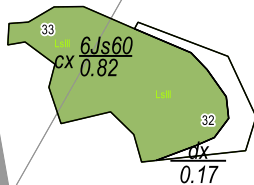

Obr. ewid.
Księginice Małe

1



50°52'30"N

50°52'30"N



35

16°46'0"E

16°46'30"E

16°44'30"E

50°53'0"N

50°53'0"N

16°44'30"E

77

78

79

80

81

83

84

169/1
b $\frac{100}{160}$
0.17

1 Obr. ewid.
Strzegomiany

zrab
c $\frac{0.73}{217}$

217

16°48'30"E

16°49'0"E

50°52'30"N

50°52'30"N

Obr. ewid.
Nasławice

1

94

126

127/2

127/1

$\frac{h}{0.08}$

$\frac{i}{0.12}$

Obr. ewid.
Świątniki

1

130

131

129/1

129/3

$\frac{90/15}{j 0.20}$

50°52'0"N

50°52'0"N

16°48'30"E

16°49'0"E



Obr. ewid. Świątniki

1

1

Obr. ewid. Księginice Małe

50°52'0"N

50°52'0"N

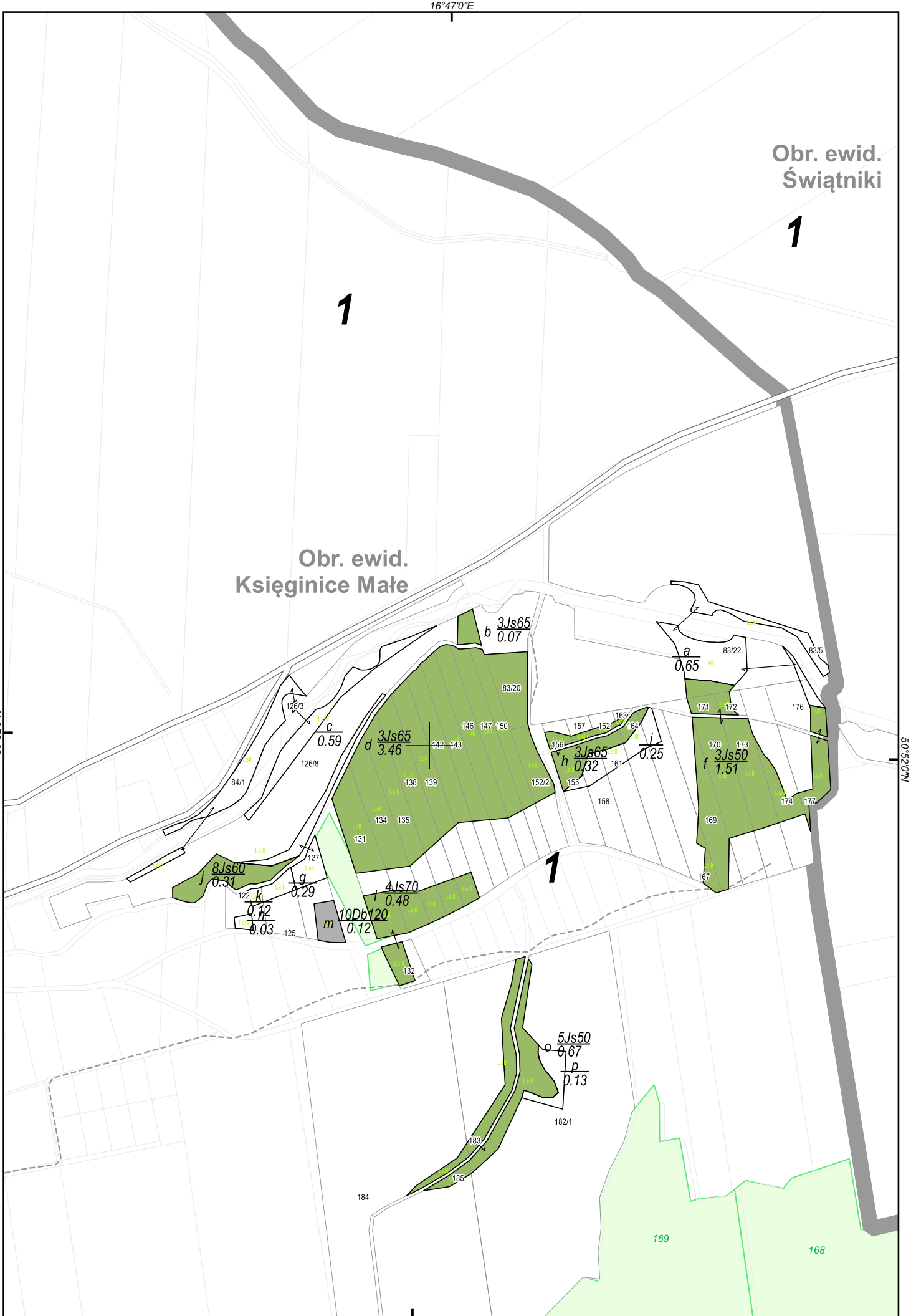

1

Obr. ewid.
Księginice Małe

70
c
0.29

1

1

211/1
5Db60
w 0.31

107/3
4Brz20
t 0.29

108/6
9Js45
s 0.13

190/1
190/2
5Js35
r 0.23

193/1
9Js60
0.18

16°45'30"E

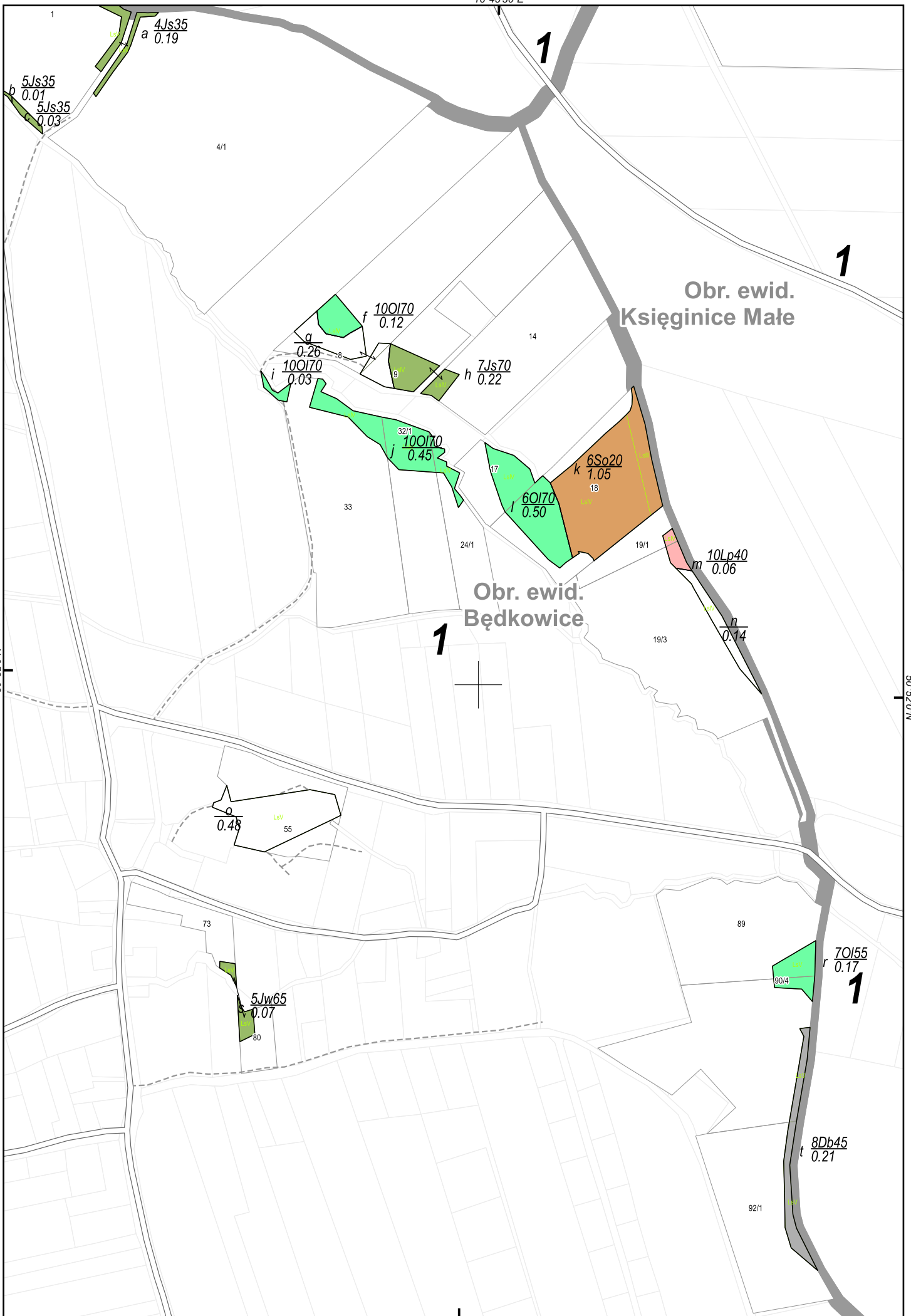

Ciąg dalszy na stronie 31

50°52'0\"/>

16°45'30"E

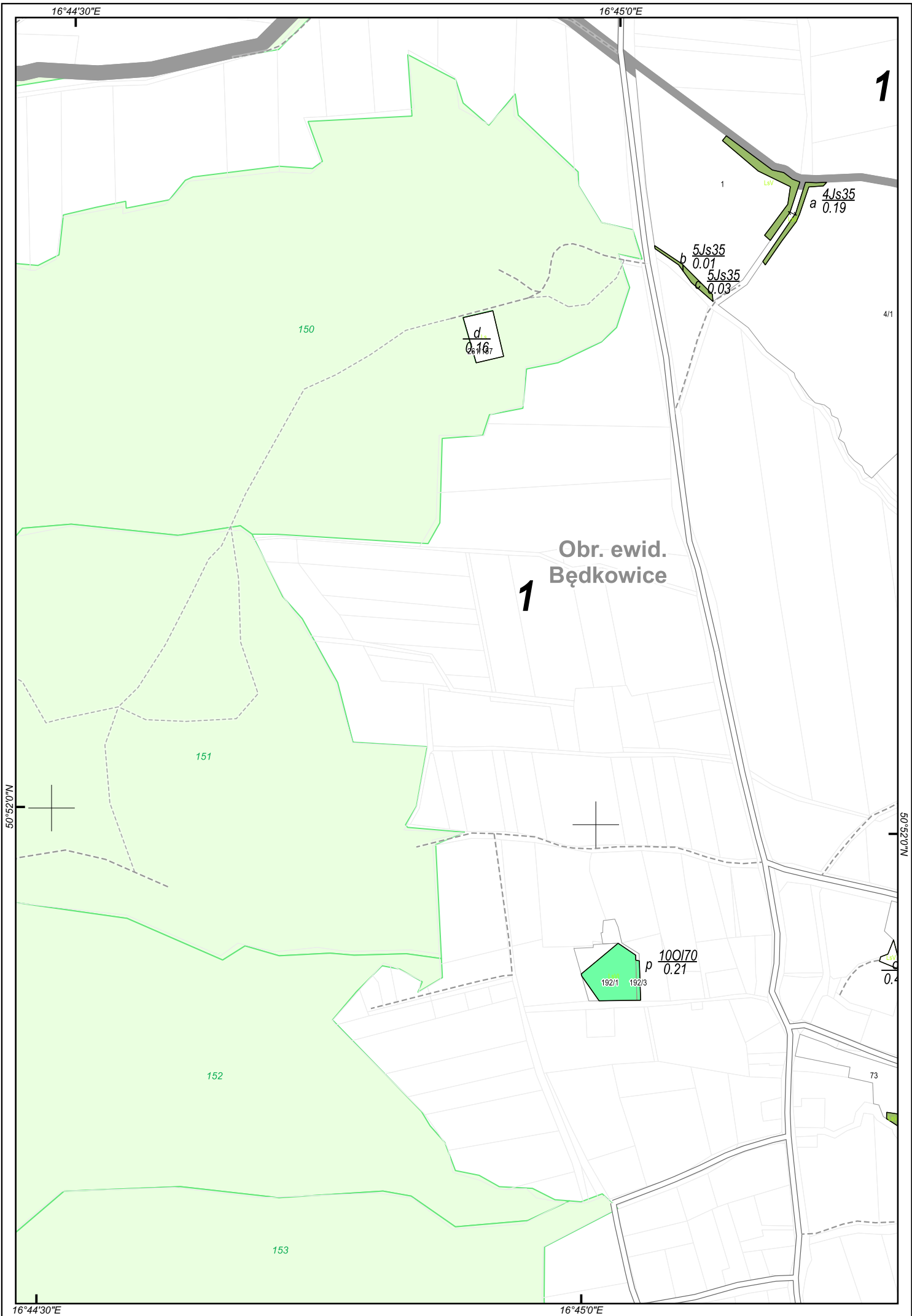

ciąg dalszy na stronie 30

16°46'30"E

ciąg dalszy na stronie 33

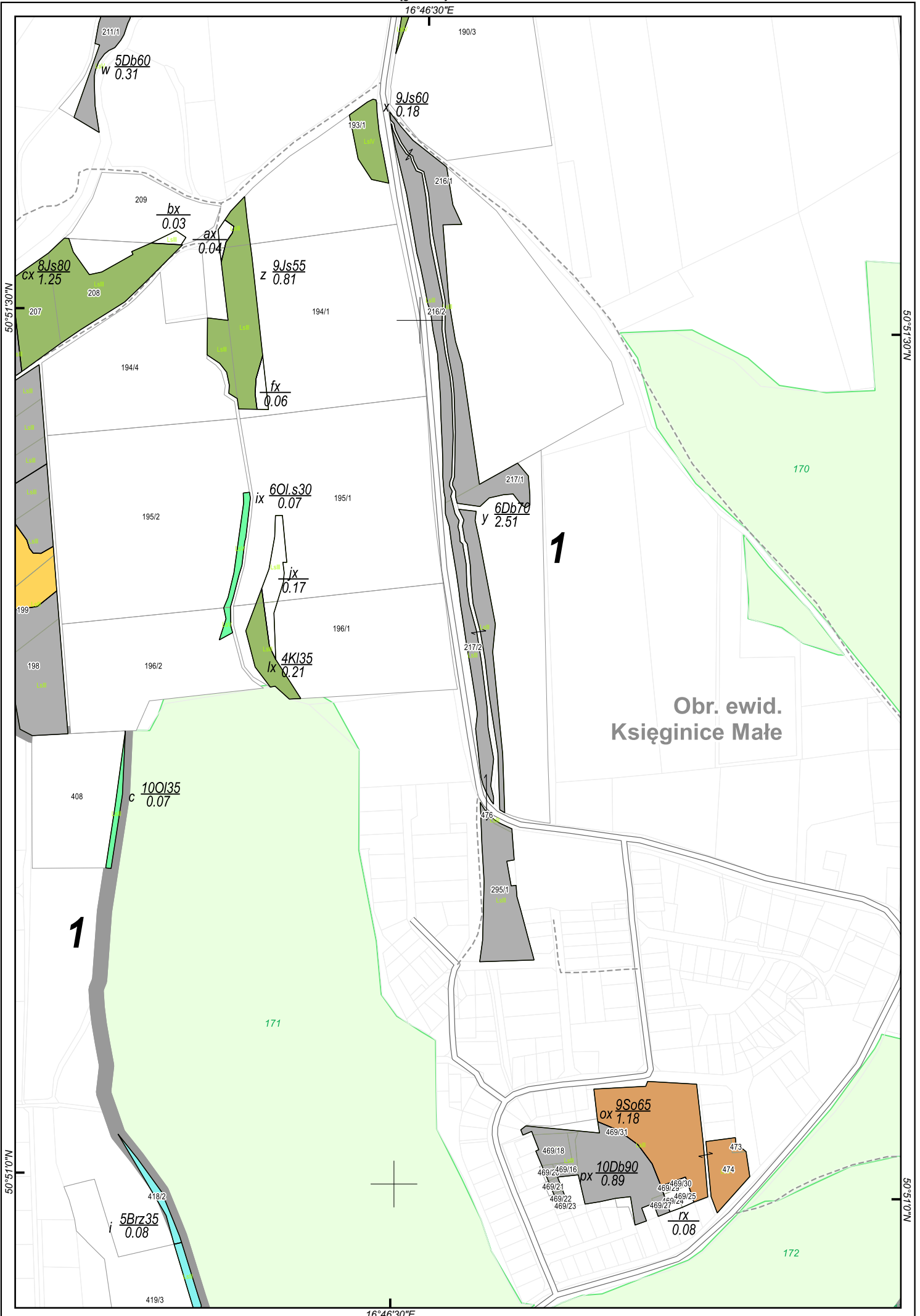

50°51'30"N

50°51'0"N

16°46'30"E

Obr. ewid.
Będkowice

Obr. ewid.
Księżynice Małe

Obr. ewid.
Sulistrowice

1

1

1

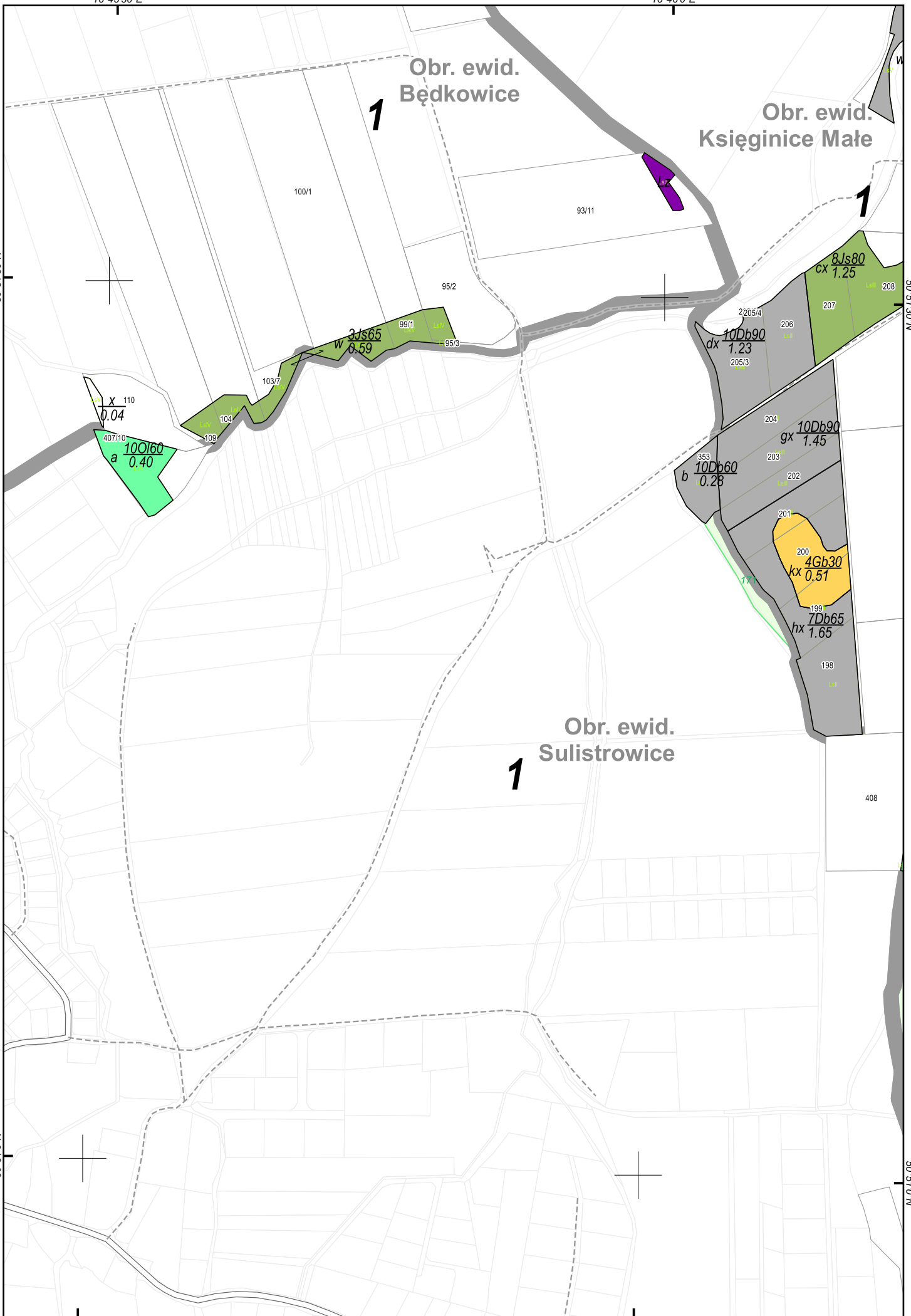

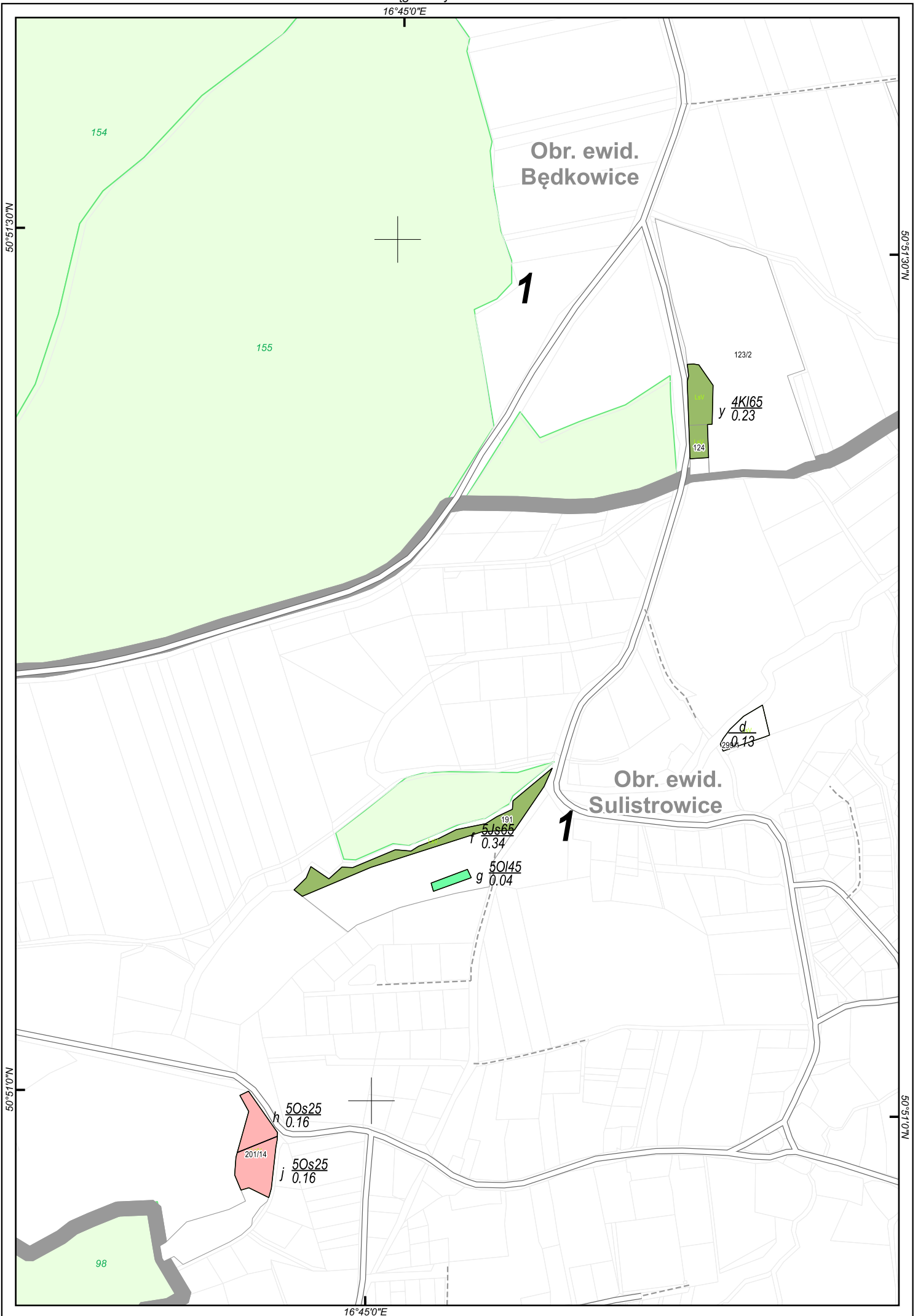

16°46'0"E

16°46'30"E

Obr. ewid.
Sulistrowice

Obr. ewid.
Księginice Małe

1

1

418/2
i 5Brz35
0.08

419/3
k 5Brz35
0.07

5Brz35
0.12

466/8
p 8Db55
0.11

466/9
o 10Brz30
0.19

466/13
r 9So60
0.09

464/3
464/11
464/4
LsV LsV LsV

462

180

179

208

207

209

171

172

175

50°51'0"N

50°51'0"N

50°50'30"N

50°50'30"N

16°46'0"E

16°46'30"E

Ciąg dalszy na stronie 36

16°45'30"E

Obr. ewid.
Sulistrowice

1

5Db70
m 0.26

475
n 8Db55
1.29

S
0.53

10So55
t 0.10

180

181

209

210

182

211

216

16°45'30"E

N 03°05.05

50°50'30"N
Ciąg dalszy na stronie 35

16°44'30"E

16°45'0"E

99

Obr. ewid.
Sulistrowice

1

255/1

w $\frac{10So75}{2.10}$

285

181

Obr. ewid.
Sulistrowiczki

102

297

x $\frac{10So65}{0.06}$

182

y $\frac{10So65}{0.16}$

291/2

292/2

211

183

184

212

213

214

16°44'30"E

16°45'0"E

50°50'30"N

50°50'30"N

